



## Technical Service BULLETIN

August 30, 2002

Title:

### IMMOBILIZER KEY CODE RESET

Models:

Applicable 4Runner, Camry, Highlander,  
Land Cruiser, MR2 Spyder, RAV4, Sequoia,  
& Solara

REVISED

SS003-01

SPECIAL SERVICE TOOLS

#### TSB REVISION NOTICE:

- June 25, 2003: Preparation procedure on page 3 now applies to all model years of MR2 Spyder.
- January 20, 2003: Updated terminals in Figure 1 on page 3.
- August 30, 2002: The information contained in this TSB supercedes the original SS003-01. Previous TSBs should be discarded.

**Introduction** Immobilizer Reset is a new feature that allows the registration of a new Master Key even if all original Master Keys are lost. Once the Immobilizer system is reset, all previously registered keys will be erased.

#### Applicable Vehicles

MODEL YEAR	MODEL	ENGINE MODEL
2000 & Later	MR2 Spyder*	1ZZ
2001	RAV4*	1AZ
2001 & Later	4Runner	5VZ
	Highlander	2AZ
	Land Cruiser	2UZ
2001 & 2002	Sequoia	2UZ
2002 & Later	Camry	1MZ & 2AZ
	RAV4	1AZ
	Solara	2AZ

\* Refer to special preparation procedure in this bulletin.

#### NOTE:

Refer to TIS (Technical Information System) for the most current applicable vehicle information.

#### Parts Information

PREVIOUS PART NUMBER	CURRENT PART NUMBER	PART NAME
N/A	Model Specific	Replacement Key (Master or Sub)



#### Warranty Information

OP CODE	DESCRIPTION	TIME	OFP	T1	T2
N/A	Not Applicable to Warranty	—	—	—	—



Toyota Supports ASE Certification

**Required  
SSTs**

SPECIAL SERVICE TOOLS (SSTs)		PART NUMBER	QUANTITY
Toyota Diagnostic Tester Kit*		01001271	1
12 Megabyte Diagnostic Tester Program Card with version 10.0a Software (or later)*		01002593-005	1
Diagnostic Check Wire (or equivalent)		09843-18020	1

\* Essential SSTs.

**NOTE:**

**Additional Diagnostic Tester Kits, Program Cards or SSTs may be ordered by calling SPX/OTC at 1-800-933-8335.**

**Function  
Description**

The Immobilizer Reset function is a 5-step process:

- Using the Diagnostic Tester, retrieve a “Seed Number” through the **OBD/MOBD Immobilizer** function.
  - A “Seed Number” is a unique number provided by the Diagnostic Tester and validated by TIS (Technical Information System) in order to return a Passcode.
- Using TIS (Technical Information System), select **Immobilizer Reset**, and complete the request form to retrieve a “Passcode Number.”
  - A “Passcode Number” is a unique number required by the Diagnostic Tester to reset the ECU allowing it to accept a new Master Key.
- Enter the “Passcode Number” received from TIS into the Diagnostic Tester.
- Confirm successful Immobilizer reset and new Master Key registration.
- Register any additional customer keys.

**Preparation:**  
 '00 & Later  
 MY MR2  
 Spyder & '01  
 MY RAV4  
 Only

Before beginning the Key Code Reset function on 2000 and later model year MR2 Spyder and 2001 model year RAV4 vehicles, it is necessary to short terminals  $T_C$  to  $E_1$  at the ECM connector, using SST No. 09843-18020. (Refer to Figure 1.)

With ECU connectors in place, back-probe and short terminals  $T_C$  to  $E_1$  (pin 17 to pin 5).

**FIGURE 1. ECM TERMINALS ON '00-'01 MY MR2 SPYDER & '01 MY RAV4**

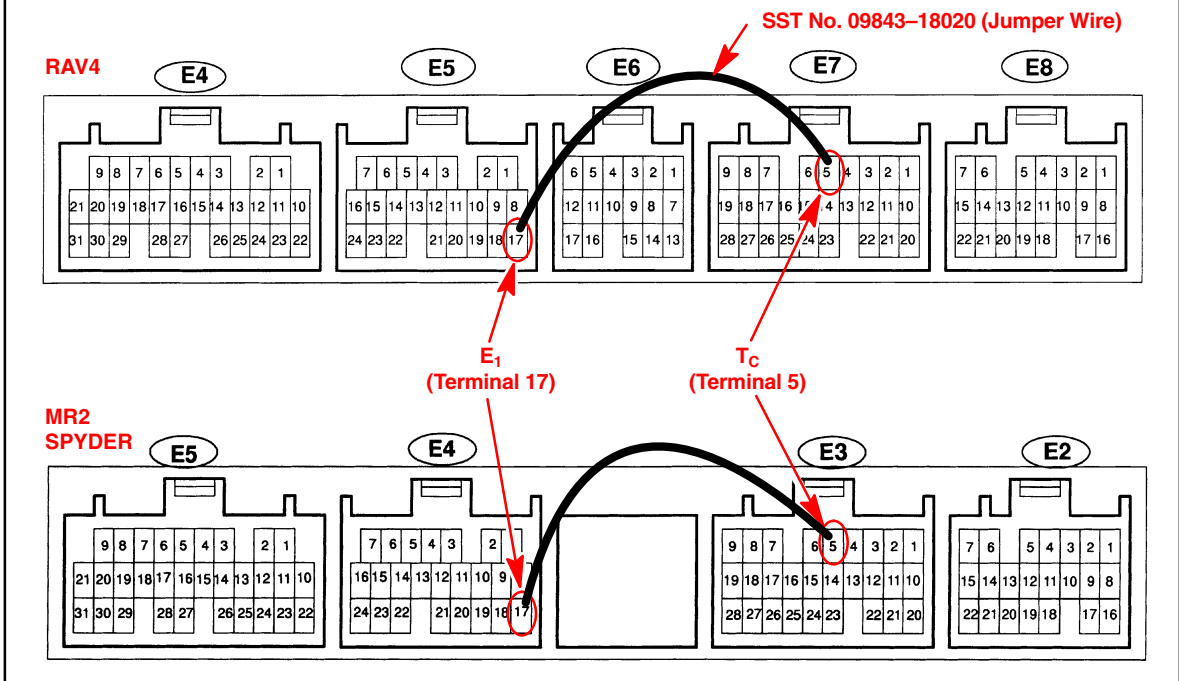

# Key Code Reset Procedure

## NOTE:

Ensure that the Diagnostic Tester is equipped with the latest version of software (9.01a or later).

Connect the Diagnostic Tester to DLC3 and turn the ignition ON.

- Using the Diagnostic Tester, follow the screen flow in Figure 2 below to retrieve the "Seed Number." (**DO NOT DISCONNECT** the Diagnostic Tester from the vehicle during this process.)

**FIGURE 2. DIAGNOSTIC TESTER SCREEN FLOW**

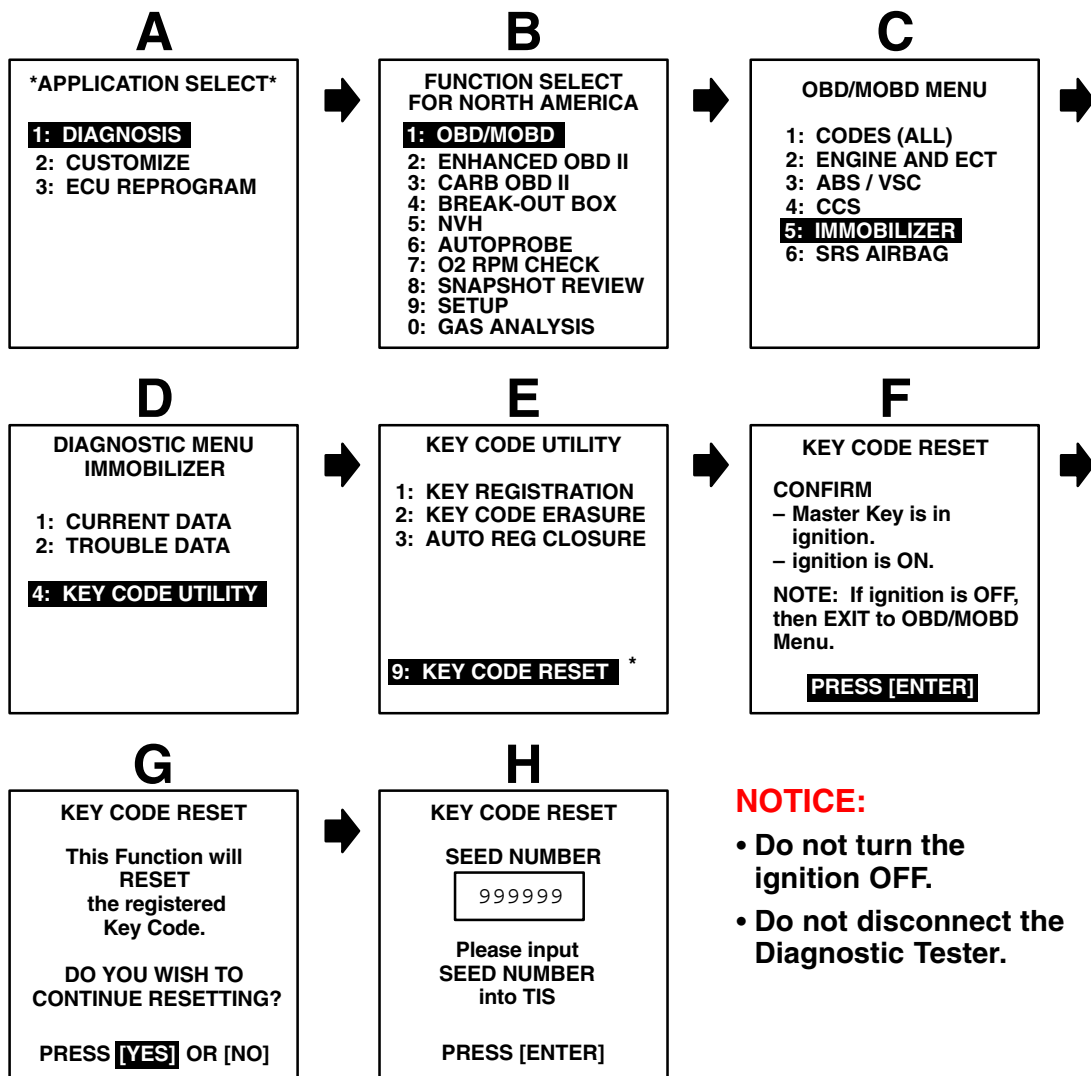

## NOTICE:

- Do not turn the ignition OFF.
- Do not disconnect the Diagnostic Tester.

\* Option "9: KEY CODE RESET" will not appear if your present vehicle does not support the key code reset functions.

**Key Code  
Reset  
Procedure**  
(Continued)

2. Using TIS (Technical Information System), select **Immobilizer Reset**, and complete the request form to retrieve a “Passcode Number.”
  - A. Click on **Diagnostics**.
  - B. Click on **Immobilizer Reset**.

**FIGURE 3. SELECTING IMMOBILIZER RESET ON TIS**

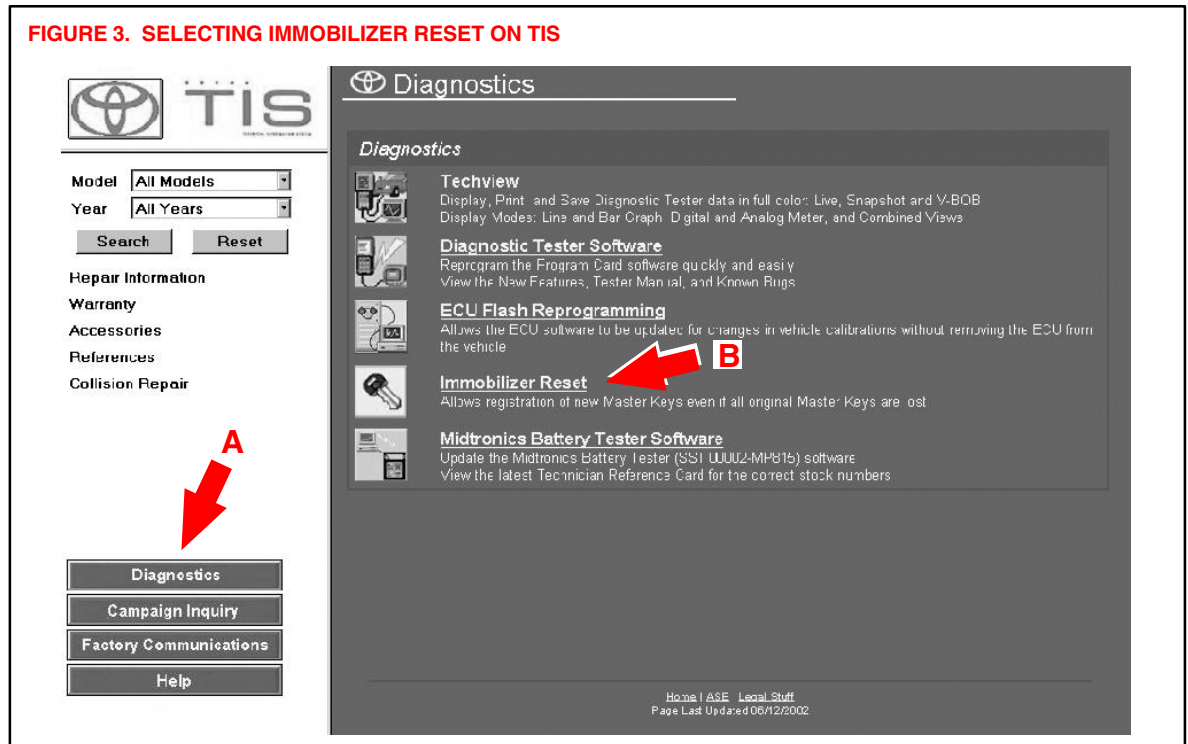

- C. Read the instructions on the screen and click on **Continue**.  
(See Figure 4 below.)

**FIGURE 4. IMMOBILIZER RESET INSTRUCTIONS ON TIS**

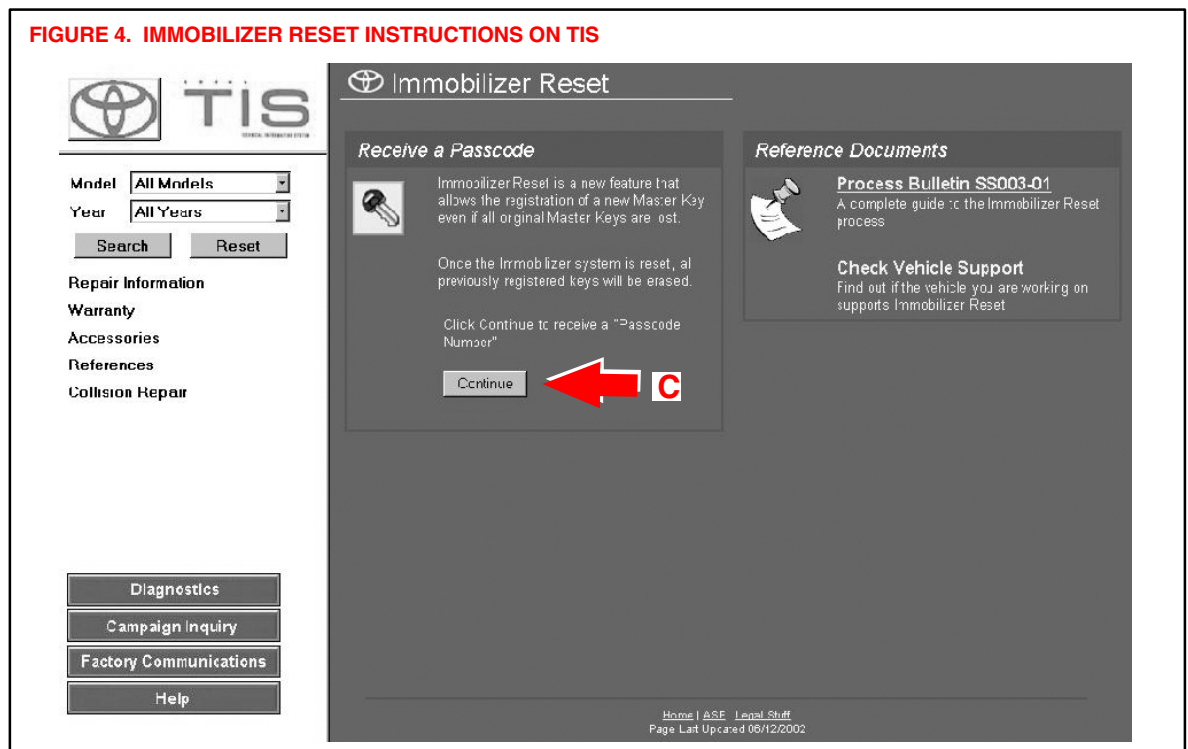

# Key Code Reset Procedure (Continued)

- D. Complete the request form and enter the “Seed Number” from the Diagnostic Tester. Click on **Request Passcode** (Figure 5).

**NOTE: All fields must be completed.**

**FIGURE 5. REQUEST FORM ON TIS**

- E. TIS will now return the Passcode that needs to be entered into the Diagnostic Tester.

**NOTE: The Passcode given by TIS is only valid for one Immobilizer Reset Event.**

**FIGURE 6. RECEIVING PASSCODE FOR DIAGNOSTIC TESTER**

**Key Code  
Reset  
Procedure**  
(Continued)

3. Using the numbered keys (0–9) on the Diagnostic Tester, enter the “Passcode Number” received from TIS. Press **ENTER** to clear all registered key codes.

**NOTE:**

**Key Code Reset takes approximately 16 minutes.**

**FIGURE 7. PASSCODE ENTRY SCREEN FLOW**

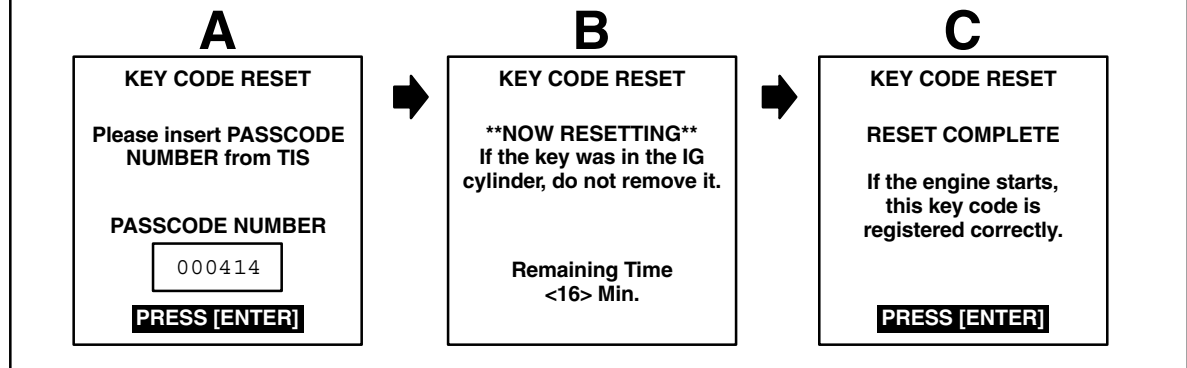

4. Confirm successful Immobilizer reset and new Master Key registration by starting the vehicle.

**NOTE:**

**If the vehicle starts, the new Master Key code is registered correctly.  
If the vehicle does not start, perform the Immobilizer Reset function again.**

5. All previously registered key codes have been erased except the Master Key used during “Key Code Reset.”

Register any additional customer keys by using “Key Registration.”

Each key will start the engine if registered correctly.

- Please refer to TSB No. SS001–99, “*Scantool Immobilizer Key Code Utility*,” for additional detail on this procedure.

**FIGURE 8. KEY REGISTRATION**

